

[www.SunCoastElevator.com](http://www.SunCoastElevator.com) - 888 229 0940 Ph



Residential elevators can be as unique as your home's interior.

Residential elevators provide convenience for people who shouldn't or don't want to climb stairs. They also add value and prestige to homes. Elevators can be designed into new home construction or added to existing homes. Inclinator elevators require less space than the competition and can be installed in nearly any home configuration.

The majority of our cars are made using hardwoods and veneers. They can be finished in our factory or in the field. Acrylic panels are used on our Elevette® 5100.

## Elevator Drive Systems

WELL-KNOWN FOR THEIR INNOVATION AND RELIABILITY

### Winding Drum

(500 lb. and 750 lb. capacity)

- ▲ Dependable
- ▲ Low maintenance
- ▲ Economical

### CD2200

(500 lb. capacity only)

- ▲ Electronic control system for winding drum mechanism
- ▲ Smooth ride
- ▲ Oilless operation
- ▲ Emergency battery backup system available
  - Backup system is automatic switching with more than 75 round trip (2 stop) cycles on battery power
  - Sleep mode extends battery life for months
- ▲ Patented

- ▲ SunCoast Elevator Co
- ▲ 10948 1/2 Grand Ave
- ▲ Temple City, CA 91780

## Elevette® 5100

C O N T E M P O R A R Y C A R

This elevator gives you a panoramic view of your home's beautiful interior...or the magnificent view outside.

#### Car:

- ▲ **Metal frame with acrylic panels**
- ▲ Custom sizes up to 12 sq. ft. (larger sizes available)
- ▲ Frame available in custom color finishes
- ▲ In-shaft or free-standing
- ▲ Automatic safety devices
- ▲ 500 lb. or 750 lb. capacity

#### Gate:

- ▲ Collapsible in anodized aluminum (black, brass, silver or white)
- ▲ Accordion fold in wood and/or acrylic panels

#### Drive System:

- ▲ Winding Drum for free-standing
- ▲ CD2200 for in-shaft



## Elevette® 4400

E L E G A N C E C A R

Today's designers of new and renovated homes usually provide space in their plans for a residential elevator. Custom-designed and built, Elevettes express your home's unique character and your personal style. Tax deductible when doctor recommended.

#### Car:

- ▲ **Raised or recessed panels**
- ▲ Solid wood with hardwood veneer center panels (acrylic inset panels available)
- ▲ Custom sizes up to 12 sq. ft. (larger sizes available)
- ▲ Custom color finishes

- ▲ In-shaft or free-standing
- ▲ Automatic safety devices
- ▲ 500 lb. and 750 lb. capacity

#### Gate:

- ▲ Collapsible in anodized aluminum (black, brass, silver or white)
- ▲ Accordion fold in wood and/or acrylic panels

#### Drive System:

- ▲ Available in all drive systems



# Elevette® 3450

## CLASSIC CAR

### Car:

- ▲ Smooth walls with crown, chair, baseboard and picture molding
- ▲ Hardwood veneer panels
- ▲ Custom sizes up to 12 sq. ft. (larger sizes available)
- ▲ Semi-gloss finish or painted in field
- ▲ Automatic safety devices
- ▲ 500 lb. and 750 lb. capacity

### Gate:

- ▲ Collapsible in anodized aluminum (black, brass, silver or white)
- ▲ Accordion fold in wood and/or acrylic panels

### Drive System:

- ▲ Available in all drive systems



# Elevette® 3400

## STYLE CAR

### Car:

- ▲ Smooth walls with square, flush corners
- ▲ Hardwood veneer panels
- ▲ Custom sizes up to 12 sq. ft. (larger sizes available)
- ▲ Custom color finishes
- ▲ Automatic safety devices
- ▲ 500 lb. and 750 lb. capacity

### Gate:

- ▲ Collapsible in anodized aluminum (black, brass, silver or white)
- ▲ Accordion fold in wood and/or acrylic panels

### Drive System:

- ▲ Available in all drive systems



# Elevette® 2100

## CONVENIENCE ELEVATOR

### Cab:

- ▲ Aluminum frame with custom snap-in panels
- ▲ Panels available in most hardwoods and laminates
- ▲ Custom sizes up to 12 sq. ft. (larger sizes available)
- ▲ Custom color finishes
- ▲ In-shaft or free-standing
- ▲ Automatic safety devices
- ▲ 500 lb. and 750 lb. capacity

### Gate:

- ▲ Collapsible in anodized aluminum (black, brass, silver or white)
- ▲ Accordion fold in wood and/or acrylic panels

### Drive System:

- ▲ Available in all drive systems



## Car Configurations

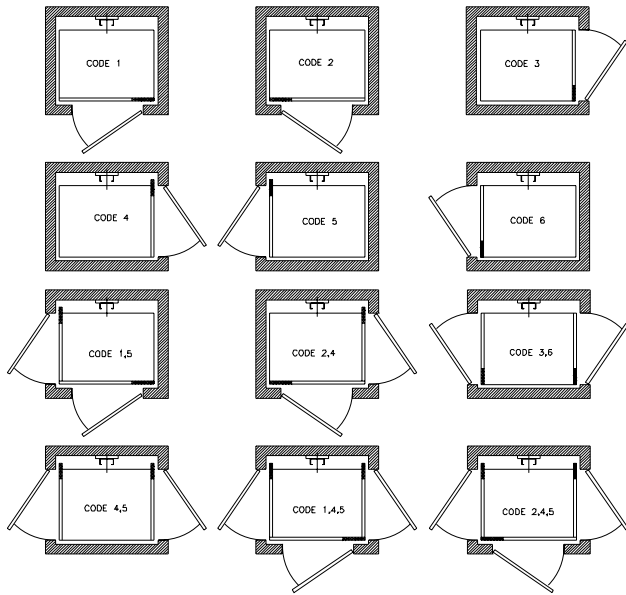

## Elevator Diagram

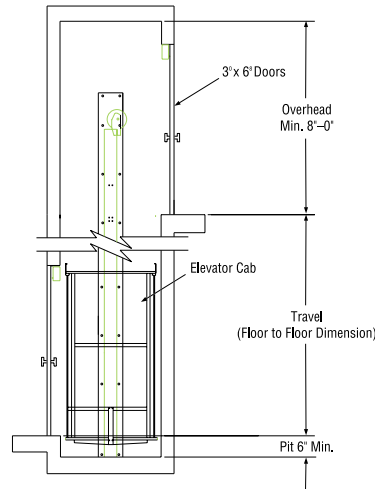

## Elevator Accessories

- Attractive finishes on car control and remote plates
  - Decorative brass or stainless steel phone boxes
  - Custom flooring – carpeting, vinyl, hardwood, etc.
  - Custom lighting
  - Various handrail finishes
- (refer to our wood finishes and accessories brochure)

Car and finished hoistway dimensions calculated the same for all drive systems.

## Car and Shaft Sizes

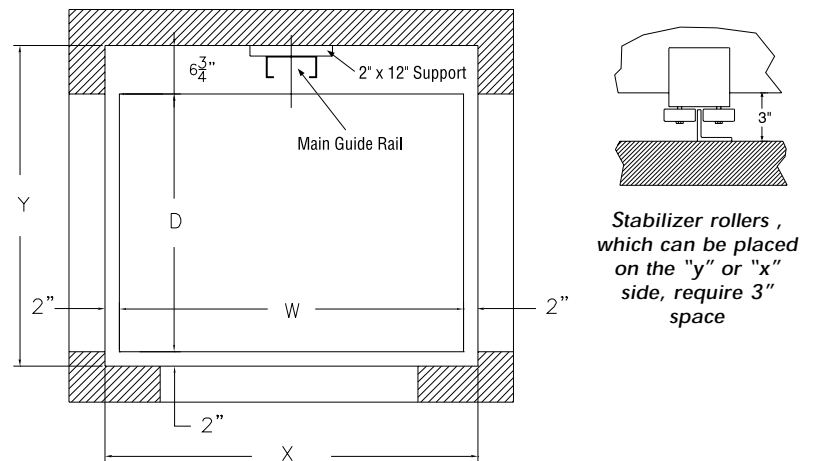

Stabilizer rollers, which can be placed on the "y" or "x" side, require 3" space

# Accessibility LIFT™

## PUBLIC ACCESS ELEVATOR OPTION

An economical, key-operated, public access elevator that's perfect for many churches, schools and meeting halls.

### Car:

- ▲ Available in all Elevette styles
- ▲ Standard 12 sq. ft. (larger sizes available)
- ▲ Custom color finishes
- ▲ In-shaft
- ▲ Automatic safety devices
- ▲ Key-operated control stations restrict access to those authorized to use equipment

- ▲ Constant pressure control or automatic controls available per local codes
- ▲ 500 lb. and 750 lb. capacity

### Gate:

- ▲ Collapsible in anodized aluminum (black, brass, silver or white)
- ▲ Accordion fold in wood and/or acrylic panels

### Drive System:

- ▲ Available in all drive systems

**INCLINATOR**  
COMPANY OF AMERICA

**SunCoast Elevator Co - 888 229 0940 Ph**

# Standard Hardwood Finishes

While the majority of our cars are made using woods and veneers in oak, maple, cherry and walnut, options include exotic woods like rosewood, teak and sweet chestnut. Cars can also be painted, in our factory or on-site, to match your interior finish.



Natural Red Oak/Semi-Gloss



Natural Birch/Semi-Gloss



Natural Cherry/Semi-Gloss

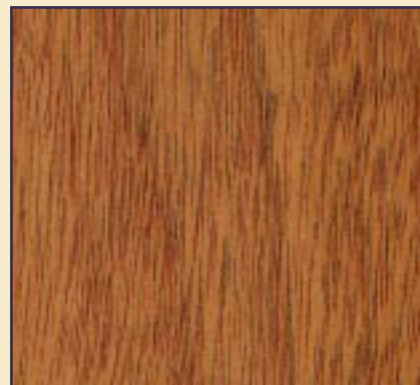

Natural Mahogany/Semi-Gloss



Natural Maple/Semi-Gloss



Natural Walnut/Semi-Gloss

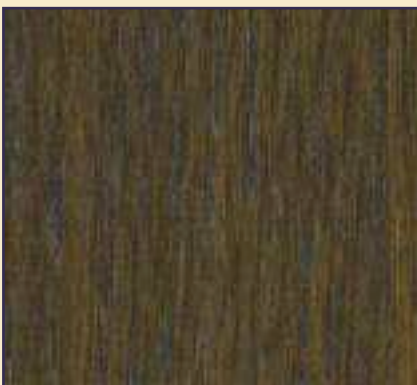

Dark Oak/Semi-Gloss



Medium Oak/Semi-Gloss

# Elevette® Information

## Car:

- ▲ Custom sizes up to 15 sq. ft.
- ▲ Custom color finishes
- ▲ Hardwood floor (finished or unfinished)
- ▲ In-shaft or free-standing
- ▲ 500 lb., 750 lb. and 950 lb. capacity

## Gate:

- ▲ Collapsible in anodized aluminum (black, silver, brass, white or bronze)
- ▲ Accordion fold in wood and/or acrylic panels (optional)
- ▲ Standard one-gate (two- or three-gate units available)

## Drive Systems:

- ▲ Winding Drum (500 lb. or 750 lb.)
- ▲ Monorail HydraRide (750 lb. or 950 lb.)
- ▲ CD2200 (500 lb. capacity only)
- ▲ Can be located in basement, attic or adjacent to shaft at landing (no overhead apparatus required)
- ▲ Runs on 220 v.1ph house current
- ▲ Call buttons on each floor

## Safety Information

### Automatic Safety Devices:

- ▲ Broken cable instantaneous dual safeties
- ▲ Overrun switch
- ▲ Car gate and entrance door interlocks
- ▲ Safety floating gate standard
- ▲ Slack cable mainline disconnect switch (Winding Drum and CD2200)
- ▲ Emergency battery raising and lowering system available (CD2200 only)
- ▲ Safety stop diaphragm and pressure-sensitive interlocked floor door (for 2-landing, cable drum open-type elevators)
- ▲ Battery lowering (HydraRide or Winding Drum)
- ▲ Key lockout standard

## Standard Gates

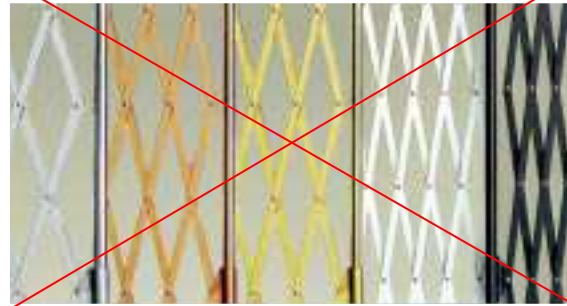

### Collapsible

Anodized aluminum (silver, bronze, brass, white, black)

## Optional Gates



### Accordion Fold

Wood and/or Acrylic panels

## Handrails



Oak Handrail



Brass Handrail



Stainless Steel Handrail



Round Brass Handrail



Round Stainless Handrail

# Car Control Plates



**Bronze Car Control Plate**  
with square LED buttons and key



**Polished Brass Car Control Plate**  
with square LED buttons and key



**Brushed Brass Car Control Plate**  
with square LED buttons and key



**Polished Stainless Car Control Plate**  
with square LED buttons and key



**Brushed Stainless Car Control Plate**  
with square LED buttons and key



**Duranotic Car Control Plate**  
with square LED buttons and key

# Remote Plates



**Polished Brass Remote Plate**  
with square LED buttons and key



**Brushed Brass Remote Plate**  
with square LED button & in-use lighted button



**Polished Stainless Remote Plate**  
with square LED buttons, arrival & in-use lighted buttons



**Brushed Stainless Remote Plate**  
with square LED buttons & in-use lighted button



**Duranotic Remote Plate**  
with square LED buttons, arrival & in-use lighted buttons



**Bronze Remote Plate**  
with square LED button



**White Kydex Remote Plate**  
with square LED buttons



**Almond Kydex Remote Plate**  
with square LED button & key

# Hardwood Veneer Floors

 Wilsonart® Flooring



Cherry



Natural Oak



Walnut



Maple

## Standard Light



6" Standard Down Light *with brass ring & and glass lens*

## 6 Inch Ring Options for Standard Light



White Ring



Polished Stainless Steel Ring



Black Ring

## Optional Lights All down lights are flush with dome.



Surface Mounted Light – 2" x 9-1/2" x 9-1/2"



6" Down Light *with black cone baffle & white trim ring*



4" Down Light *with white cone baffle*



Winding Drum Elevators  
Private Residence Only  
Oil Free / Clean and Green

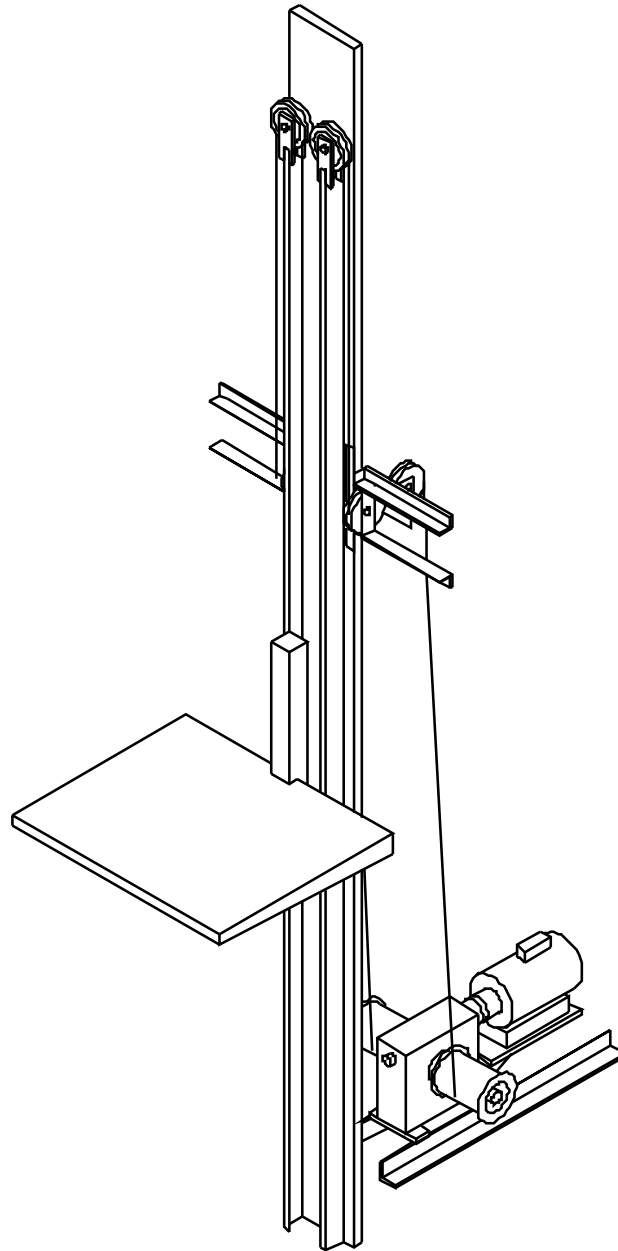

**SunCoast Elevator Co - 888 229 0940 Ph**

# Whisper Quiet Winding Drum

**We're raising the bar by lowering the noise.**

Inclinator's Winding Drum drive system has been leading the industry in performance and preference for many years. But, there remain some who prefer a hydraulic drive system because of its smoother and quieter ride – overlooking the higher cost and additional maintenance requirements. That's why we offer both systems for Elevette® residential elevators.

Last year, we introduced the Soft Start device and Emergency Battery Lowering system for the Winding Drum. Never satisfied, we continued to re-engineer our cable drum drive system and found a solution to increase its performance. Now, we're pleased to introduce the Whisper Quiet Winding Drum. It's the quietest cable drum on the market, and will be a standard on all Elevette® Winding Drums.

**We're not lowering your profits, because we're not raising the price.**

That's right. We've introduced this competitive advantage and are including it on every Winding Drum order – at no additional cost. We're committed to making continuous product improvements and want to remain the leading residential elevator manufacturer. We could sit back and relax, but we rather enjoy keeping our engineers busy making the best even better.

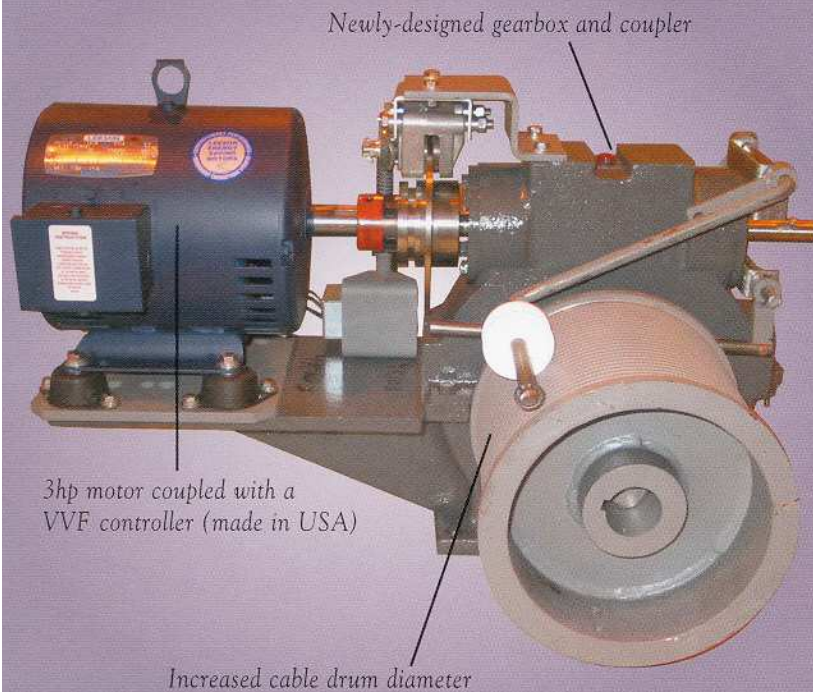

*Newly-designed gearbox and coupler*

*3hp motor coupled with a VVF controller (made in USA)*

*Increased cable drum diameter*

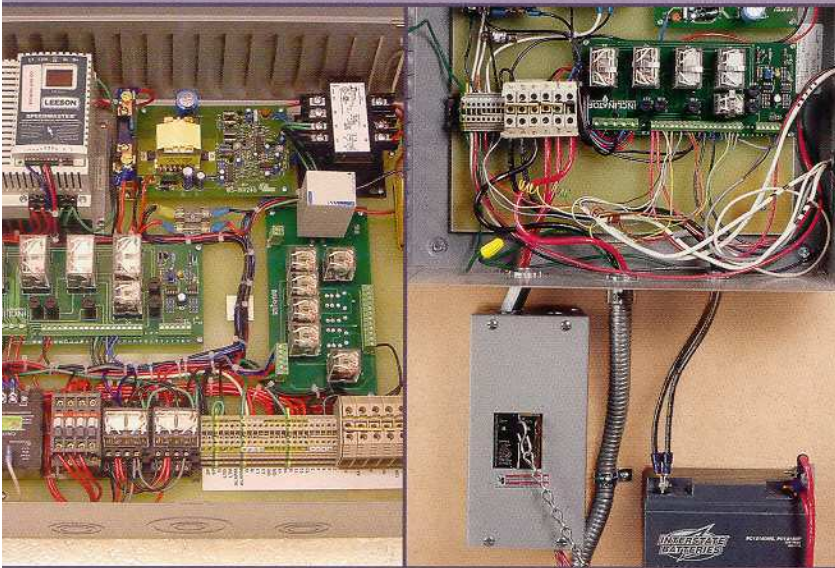

*Programmable Soft Start device  
(standard on 750 lb., optional on 500 lb.)*

*Emergency Battery Lowering system  
(optional on 500 lb. and 750 lb.)*